

# CONNECTION METHOD

## STEP 1

Download the app at  
Wilfa.com/app  
Or scan the QR-code.

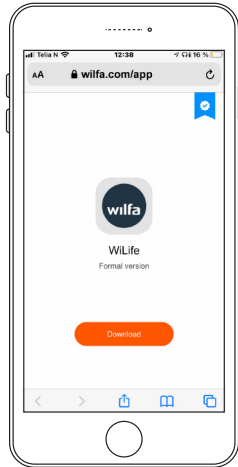

Create a user account.

## STEP 2

Ensure Bluetooth is  
enabled on your phone.  
Connect to Wi-Fi  
(network requirement: 2,4GHz)

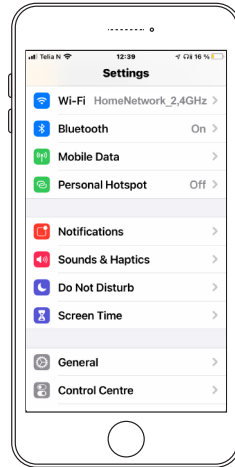

## STEP 3

Hold the on/off button  
for 3-5 seconds to make it  
searchable.



Power



Max 10 m  
distance

## STEP 4

Open the app, and press  
the plus icon in the top  
right corner.

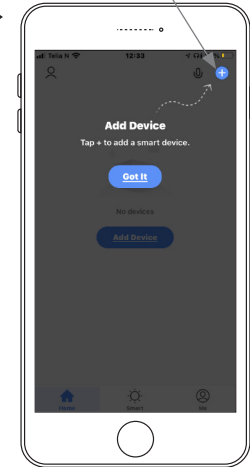

The option to add the device  
should appear automatically  
on the bottom of your screen.

➔ Follow further instructions  
on the app.

! If you experience any connection issues, please see  
instruction manual or contact [support@wilfa.com](mailto:support@wilfa.com)

i Visit web site  
for more info

